

Job Name		Engineer / Architect	
Job Location		Wholesaler	
Submittal Date		Contractor	

## DRS83 Integral Shut-Off Straight Stop w/ Screwdriver Slot – Female Iron Pipe x Male Iron Pipe

**Use:** Not intended for recirculating water systems that produce continuous use temperatures above 115° F. For those applications, use our KT™ series ball stops.

**Design Features:**

- **Machined one-piece brass body** provides strength, durability, and long-lasting performance
- **Screwdriver slot stem** helps protect against accidental stop operation during rough-ins and in general use
- Available in  No Lead

**Operating Specifications:**

**Temperature:** 40° - 140° F  
**Pressure:** 125 PSI maximum

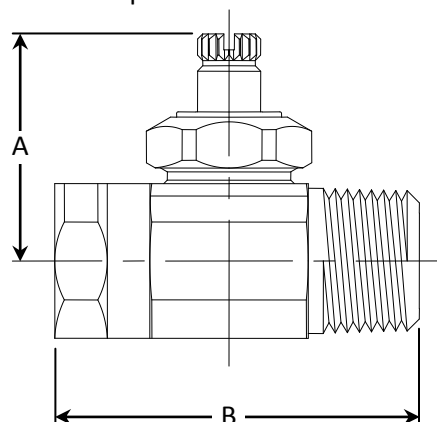

**Standard Product**

STOP MATERIAL SPECIFICATIONS	
<b>Body</b>	Brass, chrome plated
<b>Screwdriver Slot Stem</b>	Brass, chrome plated
<b>Bib &amp; Packing Washer</b>	Rubber
<b>Packing Nut</b>	Brass, chrome plated

**No-Lead Product**

STOP MATERIAL SPECIFICATIONS	
<b>Body</b>	No-Lead brass, chrome plated
<b>Screwdriver Slot Stem</b>	No-Lead Brass, chrome plated
<b>Bib &amp; Packing Washer</b>	Rubber
<b>Packing Nut</b>	Brass, chrome plated

PART DIMENSIONS (Inches)		
Model	DIM. A	DIM. B
DRS83	1.33	2.10

**Standard Part Listing:**

- DRS83 C 1/2" FIP x 1/2" MIP with screwdriver slot, chrome plated
- DRS83 R 1/2" FIP x 1/2" MIP with screwdriver slot, rough brass
- DRS83 RBT 1/2" FIP x 1/2" MIP with screwdriver slot, rough brass, bulk, plain pkg
- DRS83 R1 1/2" FIP x 1/2" MIP with screwdriver slot, rough brass, window tray

**No-Lead Part Listing:**

- DRS83X CBT 1/2" FIP x 1/2" MIP with screwdriver slot, chrome plated, bulk, plain pkg
- DRS83X RBT 1/2" FIP x 1/2" MIP with screwdriver slot, rough brass, bulk, plain pkg

**Listings & Certifications:**

- IAPMO listed to ASME A112.18.1 / CSA B125.1 (File # 0645)
- CSA listed to ASME A112.18.1 / CSA B125.1 (File # 204593)
- No-Lead product CSA listed to Low Lead Content Certification Program – Plumbing Products Class 6853-01



*This specification and all information contained herein is the confidential and exclusive property of BrassCraft Manufacturing, and shall not be disclosed to others without the written consent of BrassCraft. This specification must be returned to BrassCraft if requested.*

